

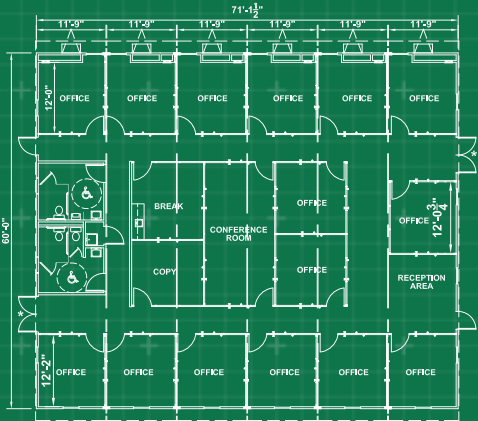

+ —

In addition to your office solution, we can provide additional products and services that complete your space- creating a more productive, comfortable, and safe work environment.



### CUSTOMIZATION

- Steps & Ramps
- Furniture & Appliances
- Technology
- Site Services
- Loss Protection

### Dimensions

64' Long (including hitch)  
72' Wide

### Exterior Finish

Vertical textured sliding perimeter frame  
Clear span EPDM roof mansard

### Interior Finish

Vinyl covered walls  
Solid core wood doors  
Carpet or tile floor  
Suspended acoustical ceiling  
Optional door locations

### Electric

Recessed diffused fluorescent lights  
Pre-wired sub panels

### Heating/Cooling

Central AC w/ electric, heat ducted supply & return

### Windows/Doors

Vertical slide insulated windows w/ blinds  
Insulated stl door in stl frame w/ vision panel

### Other

Wide open shells available

