

# 36' x 10' MOBILE OFFICE

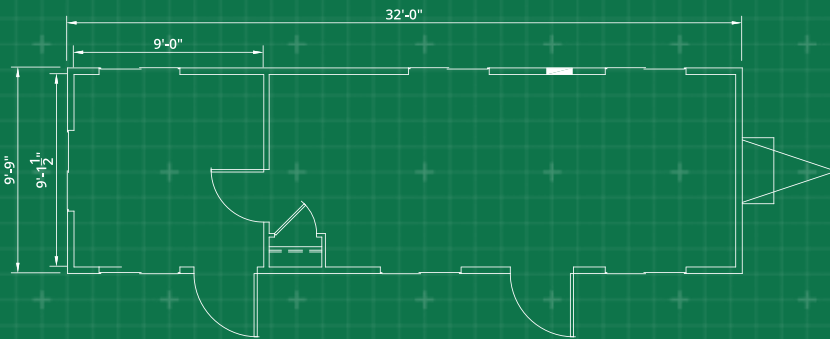

In addition to your office solution, we can provide additional products and services that complete your space- creating a more productive, comfortable, and safe work environment.



## CUSTOMIZATION

- Steps & Ramps
- Furniture & Appliances
- Technology
- Site Services
- Loss Protection

### Dimensions

36' Long (including hitch)  
 32' Box size  
 10' Wide  
 8' Ceiling height

### Exterior Finish

Aluminum or wood siding  
 I-Beam Frame  
 Standard drip rail gutters

### Interior Finish

Paneled walls  
 Carpet or vinyl tile floor  
 Gypsum or T-grid suspended ceiling

### Electric

Fluorescent ceiling lights  
 Breaker panel

### Heating/Cooling

Electric baseboard heat and thru-wall AC unit or central HVAC

### Windows/Doors

Horizontal slider windows  
 (2) Vision panel doors with standard locks or (2) steel doors with dead bolt lock

### Other

Private office(s)  
 Optional restroom

