



# 36' x 10' MOBILE OFFICE

## Dimensions

- 36' Long (including hitch)
- 32' Box size
- 10' Wide
- 8' Ceiling height

## Exterior Finish

- Aluminum or wood siding
- I-Beam frame
- Standard drip rail gutters

## Interior Finish

- Paneled walls
- Carpet or vinyl tile floor
- Gypsum or T-grid suspended ceiling
- Private offices(s)

## Electric

- Fluorescent ceiling lights
- Breaker panel

## Heating/Cooling

- Electric baseboard heat and thru-wall AC unit or central HVAC

## Windows/Doors

- Horizontal slider windows
- (2) Vision panel doors with standard locks or (2) steel doors with dead bolt lock

## Other

- Optional restroom



In addition to your office solution, we can provide additional products and services that complete your space- creating a more productive, comfortable, and safe work environment.

## CHOOSE FROM A VARIETY OF OPTIONS

- Steps + Ramps
- Furniture + Appliances
- Technology
- Site Services
- Loss Protection

## PRODUCT FLOOR PLAN

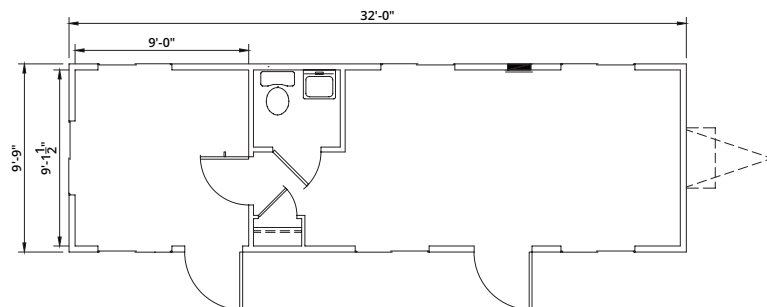

*\* Photos are representational; actual products vary. Additional floor plans and specifications may vary from those shown and are subject to in-stock availability*