



# 20' x 8' MOBILE OFFICE

## Dimensions

- 20' Long (including hitch)
- 16' Box size
- 8' Wide
- 7' Ceiling height

## Exterior Finish

- Aluminum or wood siding
- I-Beam frame
- Standard drip rail gutters

## Interior Finish

- Paneled walls
- Carpet or vinyl tile floor
- Gypsum ceiling

## Electric

- Fluorescent ceiling lights
- Breaker panel

## Heating/Cooling

- Electric baseboard heat and thru-wall AC unit or combination heat/AC unit

## Windows/Doors

- Horizontal slider windows
- Vision panel door with standard lock or steel door with dead bolt lock



In addition to your office solution, we can provide additional products and services that complete your space- creating a more productive, comfortable, and safe work environment.

### CHOOSE FROM A VARIETY OF OPTIONS

- Steps + Ramps
- Furniture + Appliances
- Technology
- Site Services
- Loss Protection

### PRODUCT FLOOR PLAN

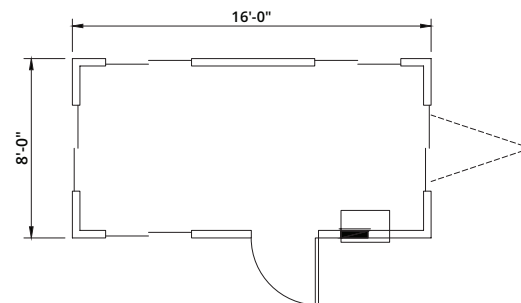

*\* Photos are representational; actual products vary. Additional floor plans and specifications may vary from those shown and are subject to in-stock availability*