

# SHORELINE SCHOOL DISTRICT SHORELINE, WASHINGTON



## Client Project

The Shoreline School District serves students in two neighboring Washington state cities, Shoreline and Lake Forest Park. The Shoreline school district is made up of nine elementary schools, two middle schools and two public high schools. Located just north of Seattle, the district serves approximately 9,000 students with a highly dedicated staff and a mission to help each student reach his or her full potential. The district is well known for its musical prowess, which goes well beyond the typical music program found in most elementary schools. While other districts have cut back funding on arts and music programs, Shoreline continues to maintain its leadership in music education, with its choirs, bands and orchestras performing at the uppermost levels.

## Client Need

The Shoreline School District needed to add space to eight of its nine elementary schools to accommodate aftercare programs as well as band and orchestra instruction, which are part of the comprehensive music program offered by the district. Each of the existing elementary schools had a designated music classroom inside each building where students attend traditional music and vocal instruction. The new permanent modular buildings would further enhance the music program by offering dedicated space where students could participate in band and orchestra. Prior to embarking on the new construction project, portable classrooms were used to accommodate students participating in the aftercare program and those attending band and orchestra classes.



# SHORELINE SCHOOL DISTRICT SHORELINE, WASHINGTON

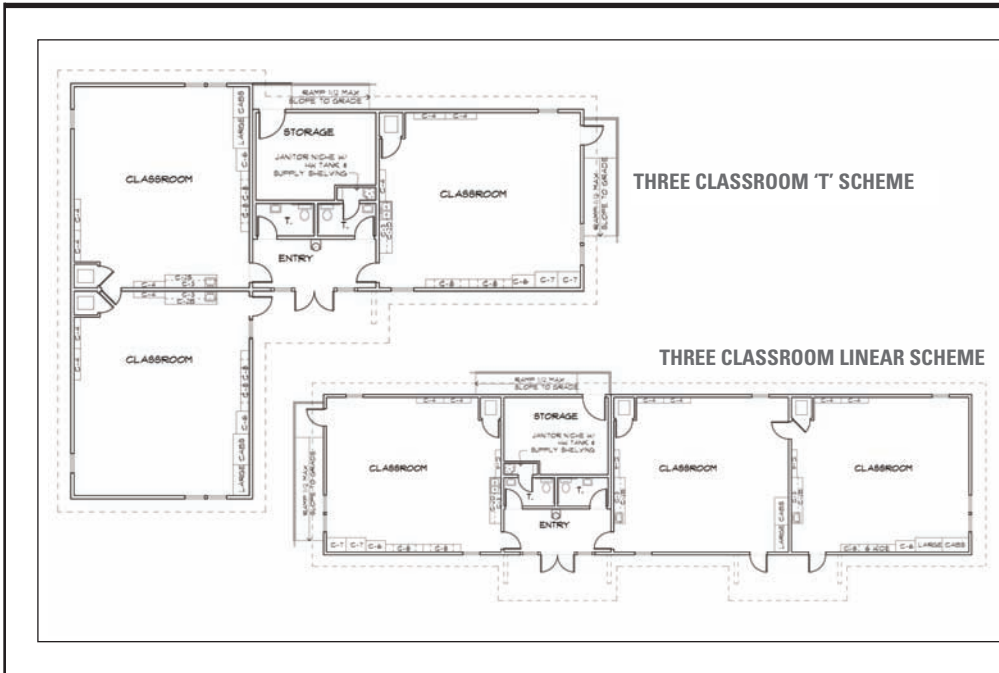

## The Williams Scotsman Solution

Modular construction allowed the Shoreline School District to complete eight detached modular structures, totaling 19 classrooms and approximately 21,077 square feet, in less time than traditional construction. The project provided schools with aftercare space that includes restroom facilities therefore eliminating the need to keep the main school building open after hours. The new buildings also provided high quality performance space and classrooms where students could foster their musical training and education. The architectural details of the new modular buildings include a dynamic contemporary style with clerestory windows to bring in lots of natural light. The exterior paint schemes closely match those of the existing school buildings, many of which were built in the 1960s, thereby creating a unified presence on campus. Williams Scotsman coordinated the various key parties involved in the construction project, including architectural firm Broweleit-Peterson-Hammer and site-work/utility contractor Shinstine Construction.

## The Result

Williams Scotsman delivered eight modular structures, which were assembled at the factory and transported to eight Shoreline elementary schools: Briarcrest, Brookside, Echo Lake, Highland Terrace, Lake Forest Park, Parkwood, Ridgecrest, and Syre. At the start of the 2008/2009 school year, five of the eight schools were able to use their brand new buildings. The remaining three buildings were all complete by the end of September 2008. With the majority of the buildings being built off-site, there was little or no disruption to students and faculty on campus.

**“The District was looking for a solution to eliminate old portables with new permanent structures and in a timely manner. The pre-fabricated modular buildings not only met the need but the end results are very functional and truly aesthetically pleasing classroom spaces.”**

– Paul Plumis

# WILLIAMS SCOTSMAN

MODULAR PROJECT  
TIMELINE:

**3 Months**

STICK-BUILT PROJECT  
TIMELINE:

**6 - 9 Months\***

\* Estimated for comparative purposes

SPACE BY



**866.972.8453**  
[www.willscot.com](http://www.willscot.com)